

## BAR

STAINLESS STEEL ROUND BAR		
BRIGHT FINISH - MINUS TOLERANCE		
SIZE	SIZE	APPROX.
(MM)	(IMP)	KG/M
3.18	1/8"	0.062
3.96	5/32"	0.1
4.76	3/16"	0.14
5		0.155
6		0.23
6.35	1/4"	0.25
7.94	5/16"	0.39
8		0.4
9.53	3/8"	0.56
10		0.62
11.11	1/2"	0.76
12		0.89
12.7	1/2"	0.994
14		1.22
14.28	9/16"	1.26
14.63		1.33
15.88	7/8"	1.552
16		1.58
17.46		1.88
19.05		2.235
20		2.47
22.23	7/8"	3.042
24		3.551
25		3.853
25.4	1"	3.973
28		4.84
28.58	1 1/8"	5.03
30		5.55
31.75	1 1/4"	6.21
33		6.72
34.93	1 3/8"	7.512
35		7.553
36		8
38.1	1 1/2"	8.94
40		9.87
41.28	1 5/8"	10.5
44.45	1 3/4"	12.17
47.63	1 7/8"	13.97
50		15.413
50.8	2"	15.9
53.97	2 1/8"	17.95
57.15	2 1/4"	20.12
60		22.2
63.5	2 1/2"	24.84
69.85	2 3/4"	30.05
76.2	3"	35.76
82.55	3 1/4"	41.98
88.9	3 1/2"	48.68
95.25	3 3/4"	55.88
101.6	4"	63.59

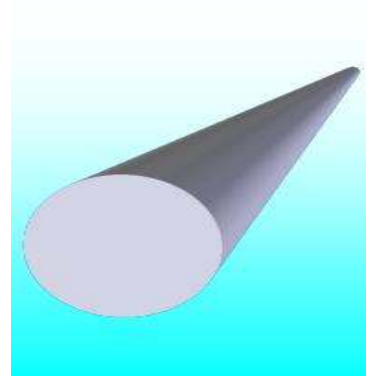

**BAR CONTINUED**

<b>STAINLESS STEEL FLAT BAR</b>		
<b>(MAY BE IMPERIAL OR METRIC)</b>		
<b>SIZE</b>	<b>SIZE</b>	<b>APPROX.</b>
<b>(MM)</b>	<b>(IMP)</b>	<b>KG/M</b>
12x3	1/2"x1/8"	0.317
20x3	3/4"x1/8"	0.48
25x3	1"x1/8"	0.63
30x3	1 1/4"x1/8"	0.79
40x3	1 1/2"x1/8"	0.948
50x3	2"x1/8"	1.3
20x5	3/4"x3/16"	0.79
25x5	1"x3/16"	0.987
30x5	1 1/4"x3/16"	1.19
40x5	1 1/2"x3/16"	1.58
50x5	2"x3/16"	1.97
65x5	2 1/2"x3/16"	2.57
75x5	3"x3/16"	2.96
12x6	1/2"x1/4"	0.648
20x6	3/4"x1/4"	0.97
25x6	1"x1/4"	1.3
30x6	1 1/4"x1/4"	1.62
40x6	1 1/2"x1/4"	1.93
50x6	2"x1/4"	2.59
65x6	2 1/2"x1/4"	3.25
75x6	3"x1/4"	3.89
100x6	4"x1/4"	5.18
20x10	3/4"x3/8"	1.58
25x10	1"x3/8"	1.97
30x10	1 1/4"x3/8"	2.43
40x10	1 1/2"x3/8"	3.16
50x10	2"x3/8"	3.96
65x10	2 1/2"x3/8"	5.13
75x10	3"x3/8"	5.93
100x10	4"x3/8"	7.9
25x12	4"x3/8"	2.59
30x12	1 1/4"x1/2"	3.25
40x12	1 1/2"x1/2"	3.89
50x12	2"x1/2"	5.18
65x12	2 1/2"x1/2"	6.48
75x12	3"x1/2"	7.77
100x12	4"x1/2"	10.36
40x16	1 1/2"x5/8"	5.05
50x16	2"x5/8"	6.48
65x16	2 1/2"x5/8"	8.21
25x20	1"x3/4"	3.96
40x20	1 1/2"x3/4"	6.32
50x20	2"x3/4"	7.9
75x20	3"x3/4"	11.9
100x20	4"x3/4"	15.8
50x25	2"x1"	10.36
75x25	3"x1"	15.48
100x25	4"x1"	20.69
127x10	5"x3/8"	10.16
150x10	6"x3/8"	11.83

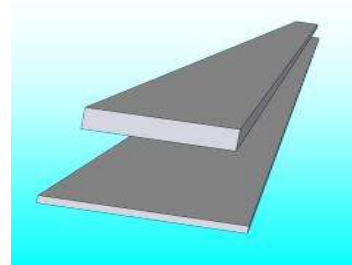

**BARS CONTINUED**

<b>STAINLESS ANGLE (PLEASE NOTE - MAY BE IMPERIAL OR METRIC SIZE)</b>		
<b>SIZE (MM)</b>	<b>SIZE (IMP)</b>	<b>APPROX. KG/M</b>
20 x 20 x 3	3/4" x 3/4" x 1/8"	0.9
25 x 25 x 3	1" x 1" x 1/8"	1.21
25 x 25 x 5	1"x1" x 3/16"	1.77
25 x 25 x 6	1"x 1"x 1/4"	2.26
30 x 30 x 3	1 1/4" x 1 1/4" x 1/8"	1.53
30 x 30 x 5	1 1/4" x 1 1/4" x 3/16"	2.25
30 x 30 x 6	1 1/4" x 1 1/4" x 1/4"	2.92
40 x 40 x 3	1 1/2" x 1 1/2" x 1/8"	1.86
40 x 40 x 5	1 1/2" x 1 1/2" x 3/16"	2.98
40 x 40 x 6	1 1/2" x 1 1/2" x 1/4"	3.56
50 x 50 x 3	2" x 2" x 1/8"	2.5
50 x 50 x 5	2" x 2" x 3/16"	3.79
50 x 50 x 6	2" x 2" x 1/4"	4.95
50x50x 10	2" x 2" x 3/8"	7.06
65 x 65 x 6	2 1/2" x 2 1/2" x 1/4"	6.16
65 x 65 x 0	2 1/2" x 2 1/2" x 3/8"	9.48
75 x 75 x 6	3" x 3" x 1/4"	7.46
75x75x 10	3" x 3" x 3/8"	11.1
100x100x6	4" x 4" x 1/4"	10.05
100x100x10	4" x 4" x 3/8"	15
127 x 127 x 10	5" x 5" x 3/8"	20.1
150 x 150 x 10	6" x 6" x 3/8"	23.7

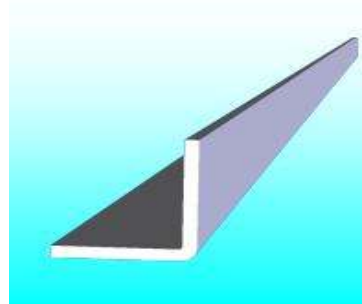

## BARS CONTINUED

STAINLESS HEXAGONS		
SIZE (MM)	APPROX. IMP SIZE	APPROX. KG/M
7.92	0.312"	0.44
8	0.315"	0.45
9.53	0.375"	0.65
11.3	0.445"	0.91
13.34	0.525"	1.25
15.24	0.600"	1.63
17	0.669"	2.02
18.03	0.710"	2.27
19.05	0.750"	2.53
20.83	0.820"	3.02
22.23	0.875"	3.43
23.37	0.920"	3.79
25.65	1.010"	4.56
28.58	1.125"	5.65
30.48	1.200"	6.42
31.75	1.250"	6.96
33.05	1.301"	7.54
34.93	1.375"	8.53
37.59	1.480"	9.86
42.42	1.670"	12.5
47.63	1.875"	15.73
50.8	2.000"	17.87
57.15	2.250"	22.57
63.5	2.500"	27.83

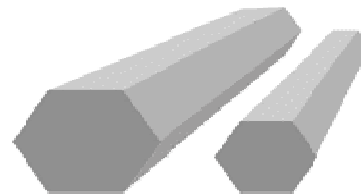

STAINLESS STEEL SQUARE BAR	
METRIC ONLY	
SIZE (MM)	APPROX. KG/M
6 X 6	0.33
8 X 8	0.53
10 X 10	0.8
12 X 12	1.27
16 X 16	2.05
20 X 20	2.98
25 X 25	5.18

