

## BENDS AND DIMENSIONS

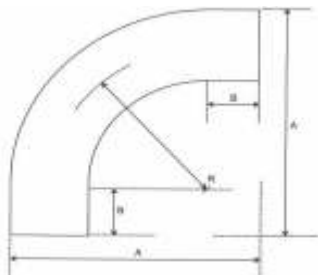

### NEW ZEALAND DIMENSIONS

Tube OD	12.7	15.9	19.1	25.4	31.8	38.1	44.5	50.8	63.5	76.2	101.6	152.4
Product Code	056*9U	066*9U	076*9U	106*9U	126*9N	156*9N	176*9N	206*9N	256*9N	306*9N	406*9U	6020*9U
Radius	19.05	23.8	28.65	38.1	57.2	76.2	79.4	101.6	114.3	139.7	152.4	228.6
Dim A	55.4	61.7	68.2	80.8	104.9	130.15	139.75	158.8	184.15	215.9	233.2	344.8
Dim B	30	30	30	30	31.8	34.9	38.1	31.8	38.1	38.1	30	40

### TOLERANCES

<b>Ovality</b>	± 0.5% of OD
<b>Square</b>	Target 0.2mm, Max 0.4mm
<b>Dim A</b>	+ 1mm -0mm
<b>Dim B</b>	Nominal
<b>Radius</b>	Nominal

### NOTE:

Product Codes: \* : 4 = T304 Stainless Steel, 6 = T316L Stainless Steel

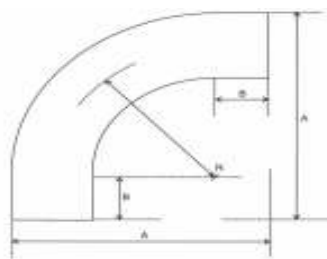

### UNI DIMENSIONS -AS1528

Tube OD	12.7	15.9	19	25.4	31.8	38.1	44.5	50.8	63.5	76.2	101.6	152.4
Product Code	056*9U	066*9U	076*9U	106*9U	126*9U	156*9U	176*9N	206*9U	256*9U	306*9U	406*9U	6020*9U
Radius	19.05	23.8	28.65	38.1	47.6	57.2	79.4	76.2	95.3	114.3	152.4	228.6
Dim A	55.4	61.7	68.2	80.8	93.5	106.2	139.75	131.6	157.1	182.4	233.2	344.8
Dim B	30	30	30	30	30	30	38.1	30	30	30	30	40

### TOLERANCES

<b>Ovality</b>	± 0.5% of OD
<b>Square</b>	Target 0.2mm, Max 0.4mm
<b>Dim A</b>	+ 1mm -0mm
<b>Dim B</b>	Nominal
<b>Radius</b>	Nominal

### NOTE:

Product Codes: \* : 4 = T304 Stainless Steel, 6 = T316L Stainless Steel

## BENDS AND DIMENSIONS

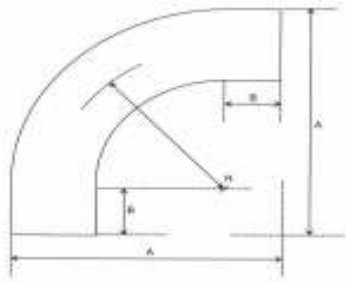

### LONG LEG DIMENSIONS

<b>Tube OD</b>	25.4	31.8	38.1	50.8	63.5	76.2	101.6
<b>Product Code</b>	10249L	12249L	15249L	20249L	25249L	30649L	40649L
<b>Radius</b>	44.5	57.2	76.2	101.6	114.3	139.7	152.4
<b>Dim A</b>	94.4	120.9	150.1	190.8	235.2	295.9	328.6
<b>Dim B</b>	37.2	47.8	54.9	63.8	89.1	118.1	125.4

### ZETAN (ZERO TANGENT) DIMENSIONS

<b>Tube OD</b>	25.4	31.8	38.1	50.8	63.5	76.2	101.6
<b>Product Code</b>	106*9Z	126*9Z	156*9Z	206*9Z	256*9Z	306*9Z	406*9Z
<b>Radius</b>	38.1	47.6	57.2	76.2	95.3	114.3	152.4
<b>Dim A</b>	50.8	76.2	76.2	101.6	127	152.4	203.2
<b>Dim B</b>	0	12.7	0	0	0	0	0

### TOLERANCES

<b>Ovality</b>	± 0.5% of OD
<b>Square</b>	Target 0.2mm, Max 0.4mm
<b>Dim A</b>	+ 1mm -0mm
<b>Dim B</b>	Nominal
<b>Radius</b>	Nominal

### NOTE:

Product Codes: \* : 4 = T304 Stainless Steel, 6 = T316L Stainless Steel

## BENDS AND DIMENSIONS

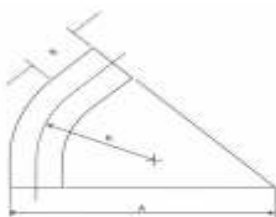

### NEW ZEALAND / UNI DIMENSIONS - AS1528

<b>Tube OD</b>	19.1	25.4	31.8	38.1	50.8	63.5	76.2	101.6	152.4
<b>Product Code</b>	07664U	106*4U	126*4U	156*4U	206*4U	256*4U	306*4U	406*4U	6020*4U
<b>Radius</b>	28.65	38.1	57.2	57.2	76.2	95.3	114.3	152.4	228.6
<b>Dim A</b>	110.5	123	136	148	174	199	225	275	401.4
<b>Dim B</b>	30	30	30	30	30	30	30	30	40

### TOLERANCES

<b>Ovality</b>	± 0.5% of OD
<b>Square</b>	Target 0.2mm, Max 0.4mm
<b>Dim A</b>	+ 1mm -0mm
<b>Dim B</b>	Nominal
<b>Radius</b>	Nominal

### NOTE:

Product Codes: \* : 4 = T304 Stainless Steel, 6 = T316L Stainless Steel

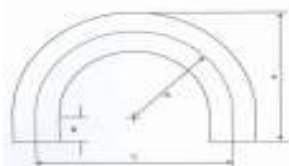

### NEW ZEALAND DIMENSIONS

<b>Tube OD</b>	25.4	31.8	38.1	50.8	63.5	76.2	101.6
<b>Product Code</b>	106*8N	126*8N	156*8N	206*8N	256*8N	306*8N	406*8U
<b>Radius</b>	44.5	57.2	76.2	101.6	114.3	139.7	152.4
<b>Dim A</b>	79.4	104.9	130.2	158.8	184.2	215.9	233.2
<b>Dim B</b>	22.2	31.8	34.9	31.8	38.1	38.1	30



### UNI DIMENSIONS

<b>Tube OD</b>	25.4	31.8	38.1	50.8	63.5	76.2	101.6
<b>Product Code</b>	10668U	12668U	15668U	20668U	25668U	30668U	40668U
<b>Radius</b>	38.1	47.6	57.2	76.2	95.3	114.3	152.4
<b>Dim A</b>	80.8	93.5	106.3	131.6	157.1	182.4	233.2
<b>Dim B</b>	30	30	30	30	30	30	30

### TOLERANCES

<b>Dim A</b>	± 1mm
<b>Dim B</b>	Nominal
<b>Dim C</b>	Nominal - typically 2 x R x 1.03. If this is critical to your end use, please talk to us first.

### NOTE:

Product Codes: \* : 4 = T304 Stainless Steel, 6 = T316L Stainless Steel